

**HYTORC<sup>®</sup>**  
*Since 1968*

## SUGGESTED HYTORC EQUIPMENT FOR STANDARD STUD AND HEAVY HEX NUT SIZES

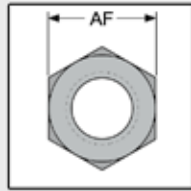
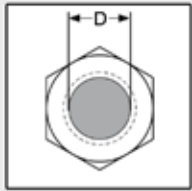

STUD SIZE (Bolt Diameter)		NUT AF (Nut Across the Flat) Req. Socket or Hex Link		SQUARE DRIVE HYDRAULIC WRENCH			LOW PROFILE HYDRAULIC WRENCH			PNEUMATIC TOOLS jGUN SERIES		
Imperial	Metric	Imperial	Metric	Avanti	MXT	Edge	Stealth	XLCT	VERSA	Single	Dual	FLIP
7/8"	M24	1 7/16"	36mm	AV-1	1MXT	E-06	ST-2	2XLCT	V-2	J-.5	DS-1	FLIP-.5
1"	M27	1 5/8"	41mm	AV-1	1MXT	E-06	ST-2	2XLCT	V-2	J-.5	DS-1	FLIP-.5
1 1/8"	M30	1 13/16"	46mm	AV-1	1MXT	E-06	ST-2	2XLCT	V-2	J-1	DS-1	FLIP-1
1 1/4"	M33	2"	50mm	AV-1	1MXT	E-2	ST-2	2XLCT	V-2	J-1	DS-1	FLIP-1
1 3/8"	M36	2 3/16"	55mm	AV-1	1MXT	E-2	ST-2	2XLCT	V-2	J-1	DS-1	FLIP-1
1 1/2"	M39	2 3/8"	60mm	AV-3	3MXT	E-4	ST-2	2XLCT	V-2	J-3	DS-3	FLIP-3
1 5/8"	M42	2 9/16"	65mm	AV-3	3MXT	E-4	ST-4	4XLCT	V-4	J-3	DS-3	FLIP-3
1 3/4"	M45	2 3/4"	70mm	AV-3	3MXT	E-4	ST-4	4XLCT	V-4	J-3	DS-3	FLIP-3
1 7/8"	M48	2 15/16"	75mm	AV-3	3MXT	E-4	ST-4	4XLCT	V-4	J-3	DS-3	FLIP-3
2"	M52	3 1/8"	80mm	AV-5	5MXT	E-8	ST-4	4XLCT	V-4	J-5	DS-5	-
2 1/4"	M56	3 1/2"	85mm	AV-5	5MXT	E-8	ST-8	8XLCT	V-8	J-5	DS-5	-
2 1/2"	M64	3 7/8"	95mm	AV-10	10MXT	E-8	ST-8	8XLCT	V-8	J-5	DS-5	-
2 3/4"	M72	4 1/4"	105mm	AV-10	10MXT	E-12	ST-14	14XLCT	V-15	-	-	-
3"	M80	4 5/8"	115mm	AV-10	10MXT	E-30	ST-14	14XLCT	V-15	-	-	-
3 1/4"	M85	5"	120mm	AV-35	20MXT	E-30	ST-22	30XLCT	V-30	-	-	-
3 1/2"	M90	5 3/8"	130mm	AV-35	20MXT	E-30	ST-22	30XLCT	V-30	-	-	-
3 3/4"	M100	5 3/4"	145mm	AV-35	30MXT	E-30	ST-36	30XLCT	V-30	-	-	-

**NOTE:** When tightening to any tool's maximum torque it is recommended to use a larger tool for loosening in case of corrosion or thread damage. The information provided is intended as a guideline only. Please refer to the manufacturer specifications for your equipment or contact your local HYTORC representative for further information.

# HYDRAULIC & PNEUMATIC TORQUE WRENCHES



## AVANTI & STEALTH

*Heavy Commercial Duty:* Over forty years of bolting experience has been built into this product line to give users the most reliable solution available today. The Avanti square drive tool and Stealth limited clearance tool use a patented technology which makes them the only true Torque/Tension tools in the market.

PAGES 5 & 6

## MXT & XLCT

*Commercial Duty:* The most widely used hydraulic wrenches in the market. The MXT square drive tool and XLCT limited clearance tool have been tried and tested for over 15 years all over the world. An ideal solution for average jobs and medium duty work.

PAGES 7 & 8



## EDGE & VERSA

*Light Commercial Duty:* A reliable product line at an affordable price. The Versa square drive tool and Edge limited clearance tool are the answer for all light duty jobs. The three-moving-part design makes these tools less likely to break and easier to repair.

PAGES 9 & 10

## TORCGUN SINGLE AND DUAL SPEED

*Pneumatic Torque/Tension:* Single speed for even and accurate final torquing or tensioning and dual speed for quick rundown and accurate final torquing with one tool. The dual speed guns eliminate the need for impact guns used for pre-torquing. The splined reaction area allows for the use of custom reaction fixtures giving the user the flexibility to adapt the tool for any application.

PAGE 11 & 12



## TORCGUN FLIP & FLASH

*Pneumatic All-In-One:* The ultimate in convenience and efficiency. The Flip Gun allows the user to rundown bolts at impact gun speeds, then apply an accurate and even final torque with a quick flip of the arm. The Flash provides constant power and speed with a standard 115v/220v connection.

PAGE 13 & 14



# TECHNOLOGY, APPLICATIONS AND ACCESSORIES



## **STRETCH-TO-LOAD TECHNOLOGY**

*The LoadDisc:* A simple accessory that fits under a standard hex nut and acts as a reaction point for the tool giving you drastically increased accuracy, safety and speed.

[PAGE 15](#)

## **MECHANICAL TENSIONING**

*The Clamp Nut:* When bolt load accuracy is critical, the Clamp Nut is the only solution that can provide accuracy within 5%. Tests conducted by various independent agencies around the world have confirmed that the Clamp Nut is far more accurate than hydraulic tensioners and much faster.

[PAGE 16](#)



## **INDUSTRY SPECIFIC APPLICATIONS**

With over forty years of experience, Hytorc has handled nearly every possible application in all industries. We have custom solutions and kits for many applications and free consultation is always available.

[PAGES 17 & 18](#)

## **HYDRAULIC PUMPS & ACCESSORIES**

Electric and air powered pumps that are designed to get the most out of every Hytorc tool. Sockets that are built to withstand heavy usage without putting the tool operator at risk. Accessories that will make our tools fit on nearly any application imaginable.

[PAGE 19 & 20](#)



## **RENTAL POLICIES & CUSTOMER SERVICE**

The only company in the world with a one year no-questions-asked warranty and a 24/7 customer service phone number that puts you in touch with a local representative anywhere in the world. Get free loaner tools with any repair, earn credits toward tool purchase with any rental, and more!

[PAGE 21 & 22](#)



# STEALTH

torque/tension machine

## TECHNOLOGY BENEFITS

- + **Increased Safety** with remote, hands-free operation, even on inverted applications
- + **2-IN-1 System** allows one tool to be used for both Regular and Critical applications.
- + **Precision Torque and Tension** - First tool with Torque accuracy of  $\pm 3\%$  and load accuracy of  $\pm 5\%$
- + **Reduced Bolting Time** - On average bolting jobs can be done twice as fast compared to other methods
- + First tool that can guarantee measurement-free, leak and failure-free joint assembly
- + One operator can control multiple tool systems
- + Built with high tensile strength Alloys (2070 Mpa) for increased tool longevity



**CLICK-IN HEX LINKS  
FAST, EASY, SAFE AND  
FME COMPLIANT!**



## STEALTH SPECIFICATIONS

Model	Torque (ft-lb)	Hex Range (in)	Weight (lb)	L	H	W	Radius
STEALTH-2	278 - 1,869	1 - 2 9/16	7.05	5.53	4.21	1.25	1.08 - 1.73
STEALTH-4	604 - 4,020	1 7/16 - 3 3/8	12.34	6.58	5.43	1.66	1.73 - 2.07
STEALTH-8	1,199 - 7,984	2 - 3 7/8	19.62	8.00	6.40	2.08	1.85 - 2.30
STEALTH-12	2,105 - 14,255	2 3/4 - 4 5/8	33.51	9.33	7.94	2.50	2.53 - 3.44
STEALTH-22	3,250 - 21,875	2 15/16 - 6 1/8	57.54	10.85	9.23	2.91	2.54 - 4.39
STEALTH-36	4,971 - 34,722	3 1/8 - 8	91.05	12.66	10.78	3.39	2.98 - 5.59

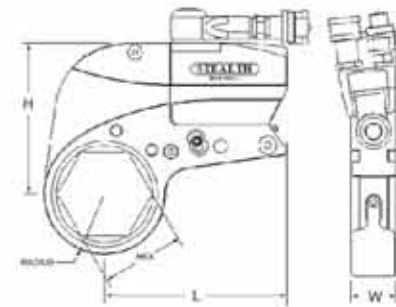

HEAVY COMMERCIAL DUTY



*The AVANTI torque/tension machine streamlines and simplifies your bolting requirements by providing coverage for both your torque and tension applications with the same system!*

# AVANTI

**torque/tension machine**

## TECHNOLOGY BENEFITS

- + **Increased Safety** with remote, hands-free operation, even on inverted applications
- + **Precision Torque and Tension** - First tool with Torque accuracy of  $\pm 3\%$  and load accuracy of  $\pm 5\%$
- + **360° Tool Indexing** around the fastener to avoid obstacles
- + **In-line Reaction** to reduce inner torsion for greater accuracy and increased tool longevity
- + **Reduced Bolting Time** - On average bolting jobs can be done twice as fast compared to other methods
- + First tool that can guarantee measurement-free, leak and failure-free joint assembly
- + One operator can control multiple tool systems
- + Built with high tensile strength Alloys (2070 Mpa) for increased tool longevity



Standard Torque



LoadISC Tension Washer



Clamp Tension Nut

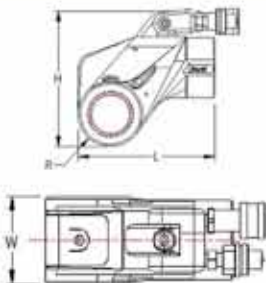

Model	Drive	Torque (ft-lb)	Weight (lb)	R	L	H	W
Avanti-.7	3/4"	113 - 767	3.9	0.92	2.93	4.21	1.77
Avanti-1	3/4"	196 - 1,284	4.3	1.14	4.71	4.70	2.17
Avanti-3	1"	428 - 2,861	9.1	1.50	6.14	6.12	2.90
Avanti-5	1 1/2"	802 - 5,459	14.6	1.80	7.36	7.10	3.38
Avanti-8	1 1/2"	1,150 - 7,760	19.8	1.88	7.91	7.65	3.90
Avanti-10	1 1/2"	1,840 - 12,456	26.9	2.13	9.20	8.90	4.35
Avanti-20	2 1/2"	2,760 - 17,890	46.7	2.50	10.84	9.90	5.00
Avanti-35	2 1/2"	4,955 - 34,060	82.4	3.01	13.06	11.93	6.02
Avanti-50	2 1/2"	7,462 - 49,750	127.4	3.39	14.71	13.44	6.79
Avanti-135	3 1/2"	13,000 - 138,500	496.0	5.25	22.52	16.38	8.50

HEAVY COMMERCIAL DUTY



# XLCT

hydraulic torque wrench



*The world's largest selling limited clearance cassette tool! Can also be used with a square drive adapter making it the ultimate 2-in-1 Torque Tool.*

## TECHNOLOGY BENEFITS

- + Longest continuous power stroke
- + One-way ratchet assures uninterrupted buildup during tightening
- + No torque reduction during loosening
- + Ideal for heavily corroded fasteners
- + Guaranteed 24 degree power stroke even at high torsion
- + 360° x 180° Dual Axis Hose Swivel
- + Torsion-resistant Uni-body Housing
- + Enforced with the Highest Strength Alloy 300,000psi (2070 Mpa)



## XLCT SPECIFICATIONS

Model	Torque (ft-lb)	Hex Range (in)	Weight (lb)	L	H1	H2	W1	W2
2XLCT	150 - 1,670	3/4 - 2 3/8	4.5	6.30	5.25	4.00	1.25	1.95
4XLCT	350 - 3,750	1 - 2 9/16	9.7	8.40	7.20	5.40	1.60	2.60
8XLCT	650 - 7,500	1 7/8 - 3 1/8	19.5	10.50	8.40	5.70	2.10	3.25
14XLCT	1,100 - 13,100	2 5/8 - 4 5/8	33.0	12.65	9.70	8.00	2.45	3.90
30XLCT	2,600 - 31,000	3 1/8 - 6 1/8	78.0	15.80	12.30	10.70	3.25	5.20

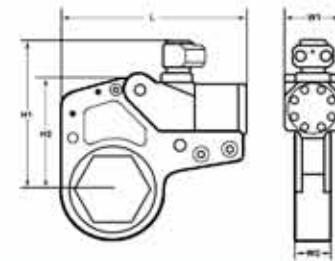

COMMERCIAL DUTY



*The MXT series is the all time most requested square drive hydraulic torque wrench by maintenance, service and construction personnel worldwide!*

# MXT

hydraulic torque wrench

## TECHNOLOGY BENEFITS

- + Longest continuous power stroke
- + One-way ratchet assures uninterrupted buildup during tightening
- + No torque reduction during loosening
- + Ideal for heavily corroded fasteners
- + Guaranteed 24 degree power stroke even at high torsion
- + 360° x 180° Dual Axis Hose Swivel
- + Torsion-resistant Uni-body Housing
- + Enforced with the Highest Strength Alloy 300,000psi (2070 Mpa)



### MXT SPECIFICATIONS

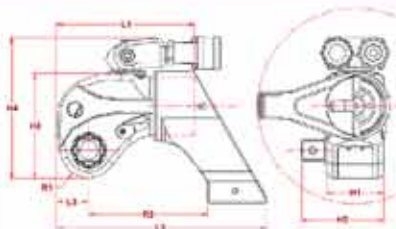

Model	Drive	Torque (ft-lb)	Wt. (lb)	L1	L2	L3	H1	H2	H3	H4	R1	R2
.5MXT	1/2"	55 - 397	3.14	3.13	4.87	0.61	1.32	1.98	2.32	3.82	0.66	2.72
.7MXT	3/4"	118 - 822	3.90	3.96	5.98	0.93	1.62	2.53	3.10	4.29	0.81	3.32
1MXT	3/4"	200 - 1,340	4.45	4.81	7.02	1.09	1.98	2.83	3.63	4.90	0.98	3.85
3MXT	1"	480 - 3,230	9.95	6.28	9.59	1.45	2.63	3.89	4.93	6.11	1.13	5.33
5MXT	1 1/2"	835 - 5,590	16.75	7.50	11.2	1.75	3.10	4.86	5.75	7.22	1.56	6.40
10MXT	1 1/2"	1,755 - 11,520	29.50	9.44	14.0	2.17	3.95	5.86	7.84	8.80	1.95	7.69
20MXT	2 1/2"	2,960 - 19,760	51.50	11.25	17.5	2.25	4.73	7.13	8.81	10.2	2.60	10.25
35MXT	2 1/2"	5,400 - 37,100	96.05	13.91	21.2	3.22	5.82	8.61	10.9	12.4	2.98	12.68
50MXT	2 1/2"	7,875 - 52,500	120.0	13.88	23.2	3.18	6.56	9.20	11.5	14.1	3.18	12.70

COMMERCIAL DUTY



# VERSA

hydraulic torque wrench



*The VERSA is the latest in 3-Moving-Part tool technology. It is the perfect solution for the budget conscious light-duty tool user.*

## TECHNOLOGY BENEFITS

- + Just 3 moving parts for increased reliability and easy maintenance
- + Slim body design to fit on all applications
- + Torsion-free action to increase tool longevity
- + Anti-lock drive pawl for easy removal
- + More turns per stroke for faster jobs
- + Quick connect cassettes for job simplicity
- + Priced below all comparable tools
- + Enforced with the Highest Strength Alloy 300,000psi (2070 Mpa)



LIGHT COMMERCIAL DUTY

## VERSA SPECIFICATIONS

Model	Torque (ft-lb)	Hex Range (in)	Weight (lb)	L	H	WR	C
V-2	160 - 1,650	1 1/4 - 2 3/16	5.2	5.50"	4.14"	1.34"	.400"
V-4	390 - 3,900	1 13/16 - 3 1/8	11.1	7.30	6.97	1.75	.543
V-8	870 - 8,700	2 3/8 - 3 7/8	20.5	9.19	7.52	2.19	.695
V-15	1,500 - 15,950	3 1/8 - 4 5/8	41.4	10.78	8.68	2.50	.900
V-30	3,000 - 30,700	3 1/8 - 6 1/8	62.0	12.25	9.93	3.00	1.15

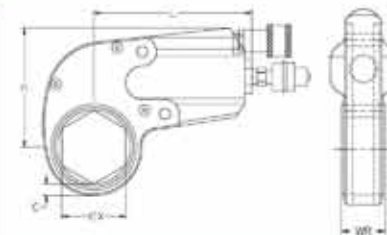



The EDGE is the economical solution in square drive hydraulic torque wrenches. A reliable 3-Moving-Part tool for light duty jobs.

# EDGE

hydraulic torque wrench

## TECHNOLOGY BENEFITS

- + Just 3 moving parts for increased reliability and easy maintenance
- + Anti-lock ratchet for easy removal
- + Uni-body housing for increased longevity
- + 360° x 180° swivel for operator convenience
- + More turns per stroke for faster operation
- + 360° adjustable reaction arm to fit on all applications
- + Priced below all comparable tools
- + Enforced with the Highest Strength Alloy 300,000psi (2070 Mpa)



## EDGE SPECIFICATIONS

Model	Drive	Torque (ft-lb)	Wt (lb)	L1	L2	L3	L4	H1	H2	H3	H4	R
E-06	3/4"	106 - 710	2.4	4.08	4.95	2.77	0.99	1.64	2.46	2.96	0.83	2.83
E-2	3/4"	175 - 1,150	4.6	4.90	5.94	3.39	1.15	1.97	2.76	3.51	0.96	3.36
E-4	1"	455 - 3,015	10.1	6.37	7.76	4.37	1.53	2.63	3.71	4.68	1.25	4.49
E-8	1 1/2"	1,230 - 8,555	25.8	8.66	10.53	5.92	2.06	3.57	5.16	6.54	1.83	6.09
E-12	1 1/2"	1,650 - 11,000	30.5	9.56	11.64	6.54	2.28	3.95	5.54	7.03	1.92	6.74
E-30	2 1/2"	4,447 - 29,646	N/A	13.51	16.62	9.35	3.28	5.64	8.21	10.08	2.77	9.70



LIGHT COMMERCIAL DUTY



# ***jGUN SINGLE***

**pneumatic multiplier**



**DIRECT TORQUE POWER**  
PLANETARY GEARS DELIVER  
ACCURATE TORQUE WITH  
LOW NOISE & VIBRATION



Model	Drive	Torque (ft-lb)	Bolt Sizes	Weight (lb)	L	H	R
J-.25	3/4"	95 - 250	1/4" - 3/4"	6.2	8.10	8.70	1.49
J-.5	3/4"	175 - 500	1/2" - 1"	6.8	8.63	8.70	1.49
J-1	3/4"	200 - 1,250	7/8" - 1 3/8"	8	9.85	8.82	1.49
J-3	1"	650 - 3,100	1 1/4" - 1 7/8"	11	12.18	9.20	1.73
J-5	1 1/2"	1,200 - 5,200	1 1/2" - 2"	19	13.69	9.65	2.04



# jGUN DUAL jGUN DUAL+

pneumatic nut runner/multiplier

## BOLTING SYSTEMS COMPARISON

**SPEED AND POWER**  
RUNDOWN SPEED UP TO  
1,400 RPM AND TORQUE  
AS HIGH AS 5,200 FT-LBS!

**THE NEW DUAL+**  
RUN IN HIGH SPEED MODE  
EVEN WITH REACTION ARMS  
AND OTHER ACCESSORIES  
ATTACHED TO THE GUN

	jGUN DUAL*	IMPACT WRENCH	PNEUMATIC TORQUE	HYDRAULIC TORQUE	HYDRAULIC TENSION
Low Weight	X	-	-	-	-
No Vibration	X	-	X	X	X
Safe for Operator	X	-	-	-	-
Reaction Arm Free	X	X	-	-	X
1400 RPM Rundown	X	X	-	-	-
Back-up Wrench Free	X	-	-	-	X
Equal Loosening Friction	X	-	-	X	-
Rundown & Torque Modes	X	-	-	-	-
Torque/Tension Compatible	X	-	-	-	-

\*Used in conjunction with JETYD Reaction Washer



### DUAL SPECIFICATIONS

Model	Drive	RPM*	Torque (ft-lb)	Bolt Sizes	Weight (lb)	L	H	R
DS-1	3/4"	1,400	200 - 1,250	7/8" - 1 3/8"	9.0	8.45	7.52	2.01
DS-3	1"	1,400	650 - 3,100	1 1/4" - 1 7/8"	17.0	11.03	7.73	2.5
DS-5	1 1/2"	1,400	1,200 - 5,200	1 1/2" - 2"	27.5	12.12	8.13	2.5

\* Dual+ operates at 175 RPM in high speed with pre-torque force of 100 ft-lbs. Specs for dimensions and weights may vary.



# jGUN FLIP

pneumatic nut runner/multiplier



## POWER

TORQUE UP TO 3,100 FT-LBS



## SPEED

RUNDOWN AT 1,600 RPM

### SAFETY

No vibration and built-in safety mechanisms that protect the operator during use.

### 2-IN-1

Faster than an impact and accurate like a hydraulic tool. One tool does the job from start to finish.

### QUICK ROI

Save time and money by using less tools and finishing most bolting jobs in nearly half the time of the previous method.

### FLIP SPECIFICATIONS

Model	Drive	Torque (ft-lb)	Bolt Sizes	Weight (lb)	L	H	R
FLIP-5	3/4"	175 - 500	1/2" - 1"	8.3	8.55	7.52	1.25
FLIP-1	3/4"	200 - 1,250	7/8" - 1 3/8"	9.5	9.04	7.52	1.5
FLIP-3	1"	650 - 3,100	1 1/4" - 1 7/8"	17.5	11.53	7.73	1.75



# ***jGUN WHEEL***

**extended dual speed multiplier**



## **DUAL SPEED WHEEL BOLTING**

- + Torque Output up to 5,200 ft-lbs
- + Ultra Durable Aerospace Metals
- + Proven Gearbox Technology
- + Rugged Design and Build Quality
- + Available in Varied Lengths



### **Power & Speed Specifications:**

	High Speed Mode		High Torque Mode	
Air Pressure (PSI)	20	90	20	90
Torque (ft-lbs)	20	72	243	944
Torque (Nm)	27.1	96.6	329	1280
Speed (RPM)	293	293	15	15



# ***STRETCH-TO-LOAD TECHNOLOGY***

**AFTER APPLYING STRETCH-TO-LOAD  
TECHNOLOGY TO NEARLY EVERY APPLICATION  
AT ONE OF THE LARGEST REFINERIES IN THE UNITED STATES  
A TOTAL OF MORE THAN 72 HOURS WAS SAVED!**



**SPEND \$600 AND SAVE A MILLION**

## **HOW CAN A WASHER SAVE A COMPANY ONE MILLION DOLLARS?**

When production time is valuable, every hour saved during an outage or shutdown translates into increased earnings. For an average cost of \$600 for tool rental and consumables, the LoDisc washer makes installation easier, increases safety, and cuts the time of most bolting jobs in half!



# MECHANICAL TENSIONING



## THE CLAMP - MECHANICAL TENSIONER

works by applying direct tension to a bolt through a three piece nut replacement. When the castellated outer sleeve is turned, the inner sleeve rises straight up and applies load to the bolt. No overstretch, no variations and no dangerous pullers.

**The increased control of variables results in no more than 10% variation in bolt load from nut to nut.**



## HYDRAULIC TENSIONERS

work by stretching a bolt near its yield point, then turning down the nut by hand or ratchet, and then releasing the stretched bolt.

**Common issues include:** bolt overstretching, uneven turning from nut to nut, variations in the amount of bolt relaxation from stud to stud, and puller safety hazards.



These variables result in **bolt load variations up to**

# 102%\*

\*As proven in independent tests (available on request)

## KNOCK OUT A 16 HOUR JOB IN 6

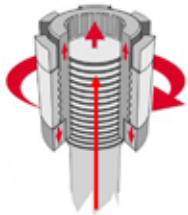

**The Clamp Nut reduces job time and increases safety** by eliminating many of the complicated and unsafe procedures required by hydraulic tensioners. It is being used on critical applications by every major oil and gas company in refineries, nuclear power stations, chemical plants, and more. The results above have been tested and proven by independent testing companies.



# APPLICATIONS BY INDUSTRY

THE APPLICATIONS LISTED AND PICTURED BELOW ARE JUST A SMALL EXAMPLE OF THE MILLIONS OF JOBS WE HAVE PERFORMED AROUND THE WORLD

## REFINERIES



Heat Exchangers - Manways - Valves - Pumps - Pipelines - Reactors - Etc

## NUCLEAR



High and Low Pressure Turbines - Steam Valves - Crossover Flanges - Feed Water Heaters - Etc.

## WIND POWER



Blade Bearing - Tower Bolts - Foundation Bolts - Shrink Disc - Gear Stay - Yaw Bearing - Etc.

## CHEMICAL



Reactors - Heat Exchangers - Manways - Pipelines - Valves - Pumps - Compressors - Etc.



# APPLICATIONS BY INDUSTRY

THE APPLICATIONS LISTED AND PICTURED BELOW ARE JUST A SMALL EXAMPLE OF THE MILLIONS OF JOBS WE HAVE PERFORMED AROUND THE WORLD



## OFFSHORE



Flanged Connections on Oil Lines & High Pressure Gas Lines - BOP's - ROV Installations - Etc.



## MINING



Tread Maintenance - Gyrotory Crushers - Earthmover Wheel Bolts & Strut Connections - Etc.



## STEEL MILL



Caster Adjustment Nuts - Gantry Bearing - Hot Mill Roller Cylinders - Cross Bearing Bolts - Etc.



## MAINTENANCE



Cement Plants - Paper Mills - Offroad Equipment - Sugar Mills - Railroads - Aircraft Assembly - Etc.



# HYTORC PUMPS

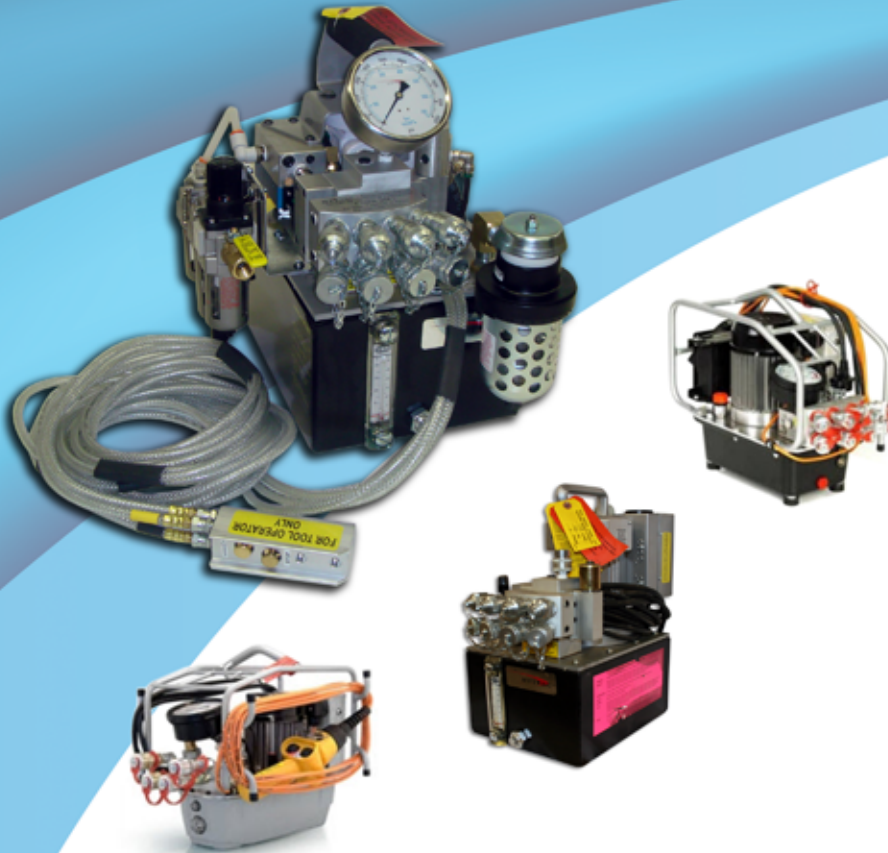

HYTORC offers an impressive lineup of high capacity, low-weight 10,000 psi portable pumps designed for continuous/heavy duty operation.

- \* CSA Approval and Certification
- \* Pressure Range 1,500 - 10,000 psi
- \* Adjustable return pressure allows for 10,000 psi on advance and return stroke if required
- \* Precision pressure adjust valve
- \* Highest flow to weight ratio of any pump manufacturer
- \* Automatic shutoff and oil dump
- \* 15' safety low voltage (24V) remote control on electric units
- \* 25' twin line 10,000 psi 'day-glo' twin line hydraulic hose c/w 4:1 safety factor
- \* Oil site gauge and drain plug
- \* Calibrated gauge (psi/kpa) with certificate
- \* 4-port manifold for multi-machine Simultorc operation (Jet-Pro 115 is equipped for single machine operation)

## PUMP SPECIFICATIONS

Model	DIMENSIONS			OIL FLOW (cu.in/min)			Power Req.	Weight (lb. with oil)	Intercooler (lb. with oil)	Explosion-Proof
	L	W	H	1 <sup>st</sup> Stage	2 <sup>nd</sup> Stage	3 <sup>rd</sup> Stage				
HYTORC 115	17.50"	9.25"	18.50"	720	55-60	-	115V 20A Single Phase	61		
QAS 115	19.75"	8.50"	18.75"	720	55-60	-	115V 20A Single Phase	66		
HYTORC AIR	14.50"	9.50"	16.25"	640	55-60	-	100-120 PSI Single Phase	65	yes	yes
JET-STREAM 115A CSA	18.75"	11.25"	15.75"	720	190	85	115V 20A Single Phase	59	yes	
JET-PRO 115A	12.50"	6.50"	12.25"	280	31	-	115V 9A Single Phase	37	yes	

# ACCESSORIES

FOR HYDRAULIC & PNEUMATIC TOOLS



Self-Releasing Back-Up Wrench Kits

Increase job safety and speed with high quality self-releasing backup wrenches. Easy to use and simple to remove with the quick hydraulic pressure release. Best of all, it makes the job completely HANDS-FREE!



A Solution For Every Application

With over 40 years experience in the industry, Hytorc has developed a solution for nearly every bolting application imaginable. Our engineering team can design and produce a custom solution to be used in manufacturing environments, in the field, or on new equipment in the design process. Please call or email to discuss your needs.



Heavy-Duty Impact Socket Sets

Increase job safety by using Hytorc brand high quality impact sockets. Each socket is designed to be used at high torque values in heavy industry environments.





# RENTAL PROGRAMS



Call us to find out more about special rental rates and our new lease-to-own programs with extended warranty coverage!

## RENTAL POLICIES

- 50% of all Rental fees will be applied as a Discount toward New Purchases\*
- 100% of all Rental Fees will be applied if purchasing the same equipment
- Free loaner tools are available if repair is needed during rental period
- Rental Tools are Guaranteed to perform on delivery
- User Training for first time Rentals is FREE of all Cost
- Return Freight Charges are FREE

\* Discount must be taken within 12 months after rental is paid

# **CUSTOMER SERVICE**

## **WORLDWIDE CUSTOMER SERVICE POLICIES**

**With the purchase of  
HYTORC®  
Torque Machines  
(past, present, future)  
you have obtained the  
latest technology and  
lifetime, worldwide  
local service.**

### **FREE SERVICES**

- ✓ **FREE User Safety Training upon Receipt of Merchandise**
- ✓ **FREE Semi-Annual User Safety Training on Request**
- ✓ **FREE Annual Safety Seminar on Appointment**
- ✓ **FREE Loaner Tools in case of Product Failure within 24 Hours**
- ✓ **FREE Torque/Tension Consultation/Seminar**
- ✓ **FREE Half Day, First Use Supervision**
- ✓ **FREE Annual Product Inspection on Request**
- ✓ **FREE Product Demonstration**
- ✓ **FREE 12 Month No-Questions-Asked Warranty**

**(Above services are NOT subject to travel expense charges)**

### **REPAIR POLICIES**

- ✓ **All Repairs are guaranteed for six months including parts and labor**
- ✓ **All Warranty Repairs are free of all charges including return-freight**
- ✓ **All Repairs will be tested and calibrated to ensure the highest quality service**
- ✓ **Repairs are subject to labor and part cost, according to official HYTORC Price List**



# HYTORC® WORLDWIDE

## USA - Headquarters

HYTORC, Division UNEX Corp.  
333 Route 17 North  
Mahwah, NJ 07430 USA  
Phone: 201-512-9500  
Fax: 201-512-9615  
Email: info@hytorc.com

## Canada

HYTORC Western Canada  
#45 Corriveau Ave  
St. Albert AB, Canada T8N 5A3  
Phone: 877-235-4733  
Fax: 780-459-8004  
Email: info@hytorcwest.ca

HYTORC Ontario  
86 Wildwood Trail  
Barrie, Ontario, Canada L4N 7Z8  
Phone: 705-737-9842  
Fax: 705-737-9110  
Email: hytorcon@rogers.com

## Central America

HYTORC Mexico  
Avenida Lazaro Cardenas No. 1002  
Colonia Maria de La Piedad  
C.P. 96410 Coatzacoalcos, Veracruz, Mexico  
Phone: 921 21 52760  
Fax: 921 21 52785  
Email: coisa@hytorc.com.mx

## South America

HYTORC Brasil  
Rua da Candelaria, 97 - Centro  
Rio de Janeiro - RJ - CEP: 20091-020, Brazil  
Phone: 21 2223-2944  
Fax: 21 2223-3054  
Email: comercial@hytorc.com.br

## United Kingdom

HYTORC United Kingdom  
Unit 24A, Spencer Court, Blyth Industrial Estates  
Blyth, Northumberland  
NE24 5TW, United Kingdom  
Phone: 01 670 363800  
Fax: 01 670 363803  
Email: sales@hytorc.co.uk

## France - Spain - Italy - Belgium - Greece

HYTORC Europe  
2 Square Mozart  
75016 Paris, France  
France: 33 1 42 88 67 45  
Spain: 900 902 111  
Italy: 800 782 522  
Belgium: 0800 15 399  
Fax: 33 1 42 88 66 96  
Email: info@hytorc.fr

## Central Europe & C.I.S. Countries

HYTORC Central Europe & C.I.S.  
Wienergasse 146  
A-2380 Perchtoldsdorf, Austria  
Phone: 43 1 86 51 368  
Fax: 43 1 86 51 892  
Email: info@hytorc-centraleurope.com

## Germany - Austria - Switzerland - Turkey

Barbarino & Kilp GmbH  
Justus-von-Liebig-Ring 17,  
Gerwerbegebiet Kim 2  
D-82152 Krailling, Germany  
Phone: 089 230 999 0  
Fax: 089 230 999 11  
Email: info@hytorc.de

HYTORC Drehmomentmaschinen Seis GmbH  
Bergstrasse 9  
D-56290 Beltheim-Frankweiler, Germany  
Phone: 06762 40950  
Fax: 06762 409540  
Email: info@hytorc-seis.de

## Holland

HYTORC Nederland B.V.  
Platinawerf 8  
NL - 6641 TL Beuningen  
The Netherlands  
Phone: 31 0243 660 660  
Fax: 31 0243 480 090  
Email: info@hytorc.nl

## Scandinavia

HYTORC Norge  
Sandesletta 14 - 4050 Sola  
Box 334 - N4067 Stavanger, Norway  
Phone: 051 71 54 00  
Fax: 051 71 54 01  
Email: kundeservice@hytorc.no

## India

HYTORC Mumbai  
Hasti Industrial Estate Premises Co-op LTD.  
Plot no. 798, Unit 25  
MIDC, Mahape, Navi Mumbai, 400 709 M.S. INDIA  
Phone: 022-27781898  
Fax: 022-27782928  
Email: hytorc@vsnl.com

## China

HYTORC China  
19/F, No.2, 1040 Lane, Caoyang Road  
Shanghai, 20063, P.R.C.  
Phone: 86 21 62540813  
Fax: 86 21 62540968  
Email: info@hytorchina.com

## Japan

HYTORC Japan  
3-62-6 Koenji Minami  
Suginami-ku, Tokyo 166-0003, Japan  
Phone: 03 3314 3345  
Fax: 03 3314 3077  
Email: info@hytorc.co.jp

## Australia - New Zealand - SE Asia - S. Africa

HYTORC South Pacific  
6 Eton Road  
Keswick, 5035 South Australia  
Phone: 61 8 8293 8411  
Fax: 61 8 8297 0948  
Email: hytorcoz@ozemail.com.au

## Middle East

HYTORC Middle East WLL  
PO Box 54064  
Kingdom of Bahrain  
Phone: 973-177-45-870  
Fax: 973-166-27-856  
Mobile: 973-394-12-546  
Email: lg@hytorcibt.com

## North Africa

BOLTING TECHNOLOGY HYTORC DEPT  
Parc de Fontaudin, Avenue Descartes  
33370 Artigues-pres-Bordeaux, France  
Phone: +33-5-5677-5000  
Fax: +33-5-5677-5052  
Mobile +33 680 454 843  
Email : ml@hytorcibt.com